

SPECIFICATION

FREQUENCY: 30-88 MHz
 225-450 MHz
 INSTANTANEOUS BANDWIDTH: VHF = 60 MHz
 UHF = 225 MHz

POLARIZATION: VERTICAL
 INPUT IMPEDANCE: 50 OHMS NOMINAL
 INPUT POWER: 30-88 MHz = 150 WATTS CW
 225-450 MHz = 100 WATTS CW
 RF CONNECTOR: 30-88 MHz = TYPE BNC
 225-450 MHz = TYPE BNC
 VSWR: 30-88 MHz = AVERAGE 3.5:1 OR LESS
 225-450 MHz = AVERAGE 3.0:1 OR LESS
 GAIN: 30-88 MHz = -2 TO +4 dBi
 225-450 MHz = -4 TO +5 dBi

WEIGHT: 10 LBS APPROXIMATE
 COLOR: GREEN, TAN, BLACK

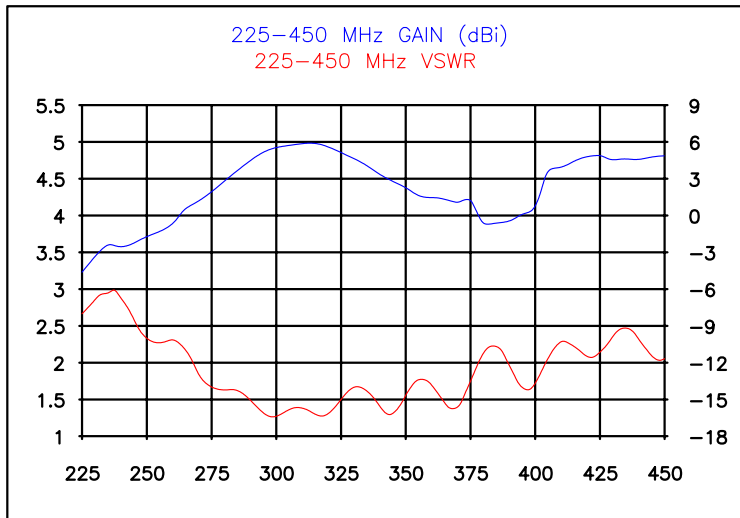
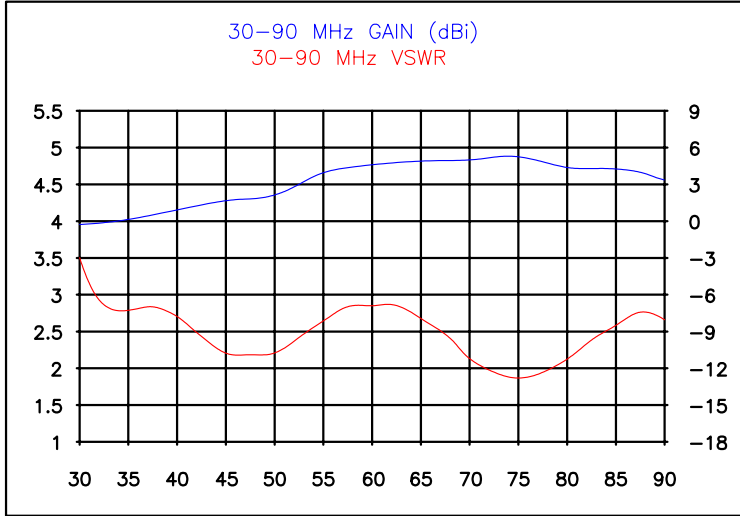

FOUR .438" DIA HOLES
 SPACED 90° APART ON
 4.5" BOLT HOLE CIRCLE

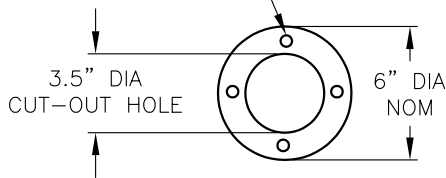

BOLT HOLE MOUNTING PATTERN

FEMALE "BNC" CONNECTOR

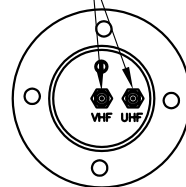

BOTTOM VIEW

1" NOM

89" NOM

ASSEMBLED HEIGHT
 99" NOM

10" NOM

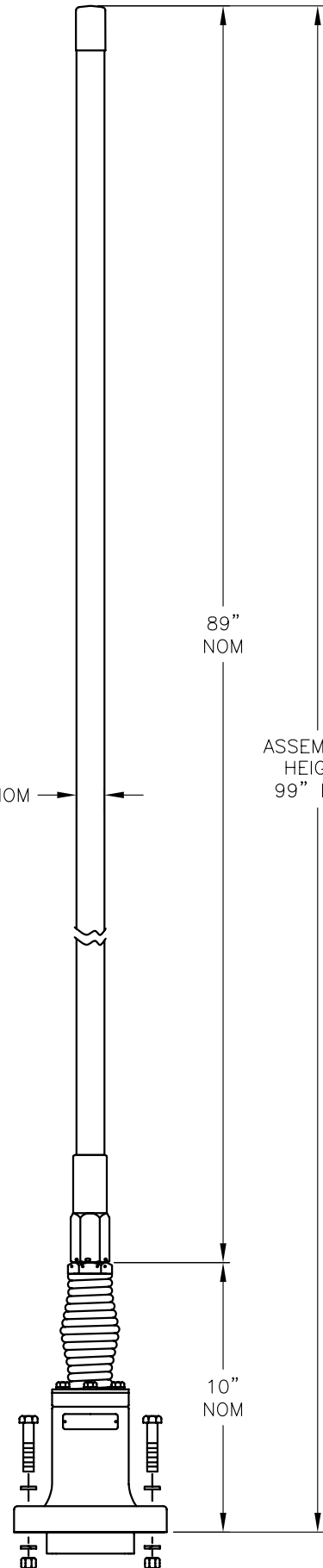

DO NOT SCALE DRAWING

UNLESS OTHERWISE SPECIFIED
 DIMENSIONS ARE IN INCHES.
 .X = ± TOL_X
 .XX = ± TOL_XX
 .XXX = ± TOL_XXX
 ANGLES = ± TOL_ANG



DRAWN: HRJ ENG APPROVAL: SCALE: - DATE: 3/5/2010

DUAL BAND ANTENNA
 30-88, 225-450 MHz

PART# DB-3450/VRC

REV	DESCRIPTION	BY	DATE